

COUNTER FLASHING WALL TERMINATION

1. Wall Facing (installed by others)
2. Metal Counter Flashing
3. True Seal™ Caulking
4. True Seal™ Term Bar Butyl Tape
5. True Seal™ Fastener

6. True Seal™ Bonding Adhesive
7. True Seal™ Membrane (Flashing)
8. Field weld (minimum 1.5")
9. True Seal™ Approved Insulation and/or Cover Board

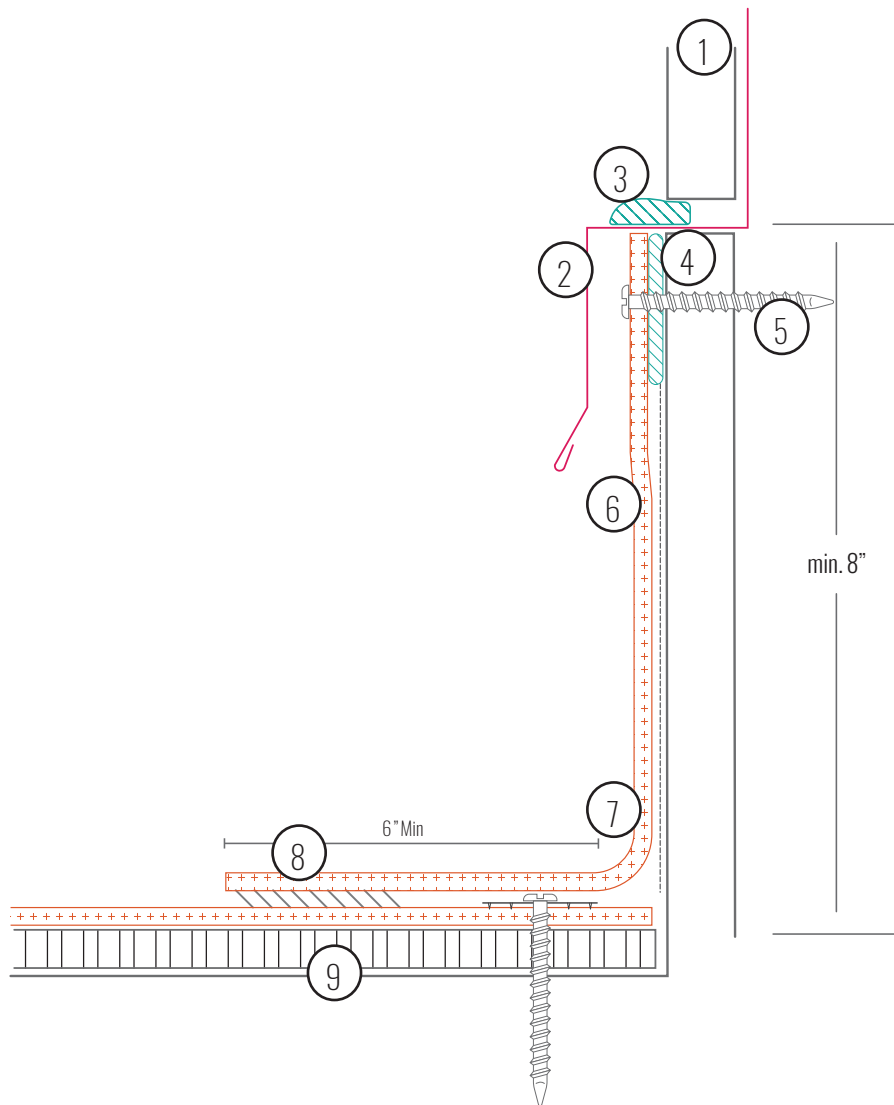

Notes:

- True Seal™ fastener must penetrate membrane and term bar butyl tape
- Minimum height above finished roof level is 8"
- Metal counter flashing must be securely fastened behind the wall facing (by others)
- At all times, the seam overlap area must be dry before field seam hot air welding
- At all times, the seam overlap area must be free of dirt, debris and contaminants before field seam hot air welding.
- Were the vertical face dimension of the metal counter flashing exceeds 3", a starter strip must be installed and fastened at a maximum of 24" on center through the term bar butyl tape.
- Perimeter securement of the field membrane with True Seal fasteners and True Seal metal membrane plates shall be at 12" on center.
- True Seal™ flashing membrane must be 100% adhered in True Seal™ Low VOC @ 60ft²/gallon.
- Vertical insulation or cover board (if applicable) must be fastened at a rate of 1 True Seal™ Fastener and insulation plate per 2 sqft
- Please contact the True Seal™ Technical Department for clarifications or questions at tech@true-seal.com