

1. True Seal™ Pitch Pan
2. Roof Penetration (by others)
3. True Seal™ Sealant
4. True Seal™ Pourable Sealant
5. Approved Filler/Sealer
6. Field Seam (minimum 1.5")
7. Approved True Seal™ Insulation and/or cover Board
8. Roof Deck
9. True Seal™ Membrane
10. True Seal Approved Fastener
11. Field Seam overlap (minimum 3")

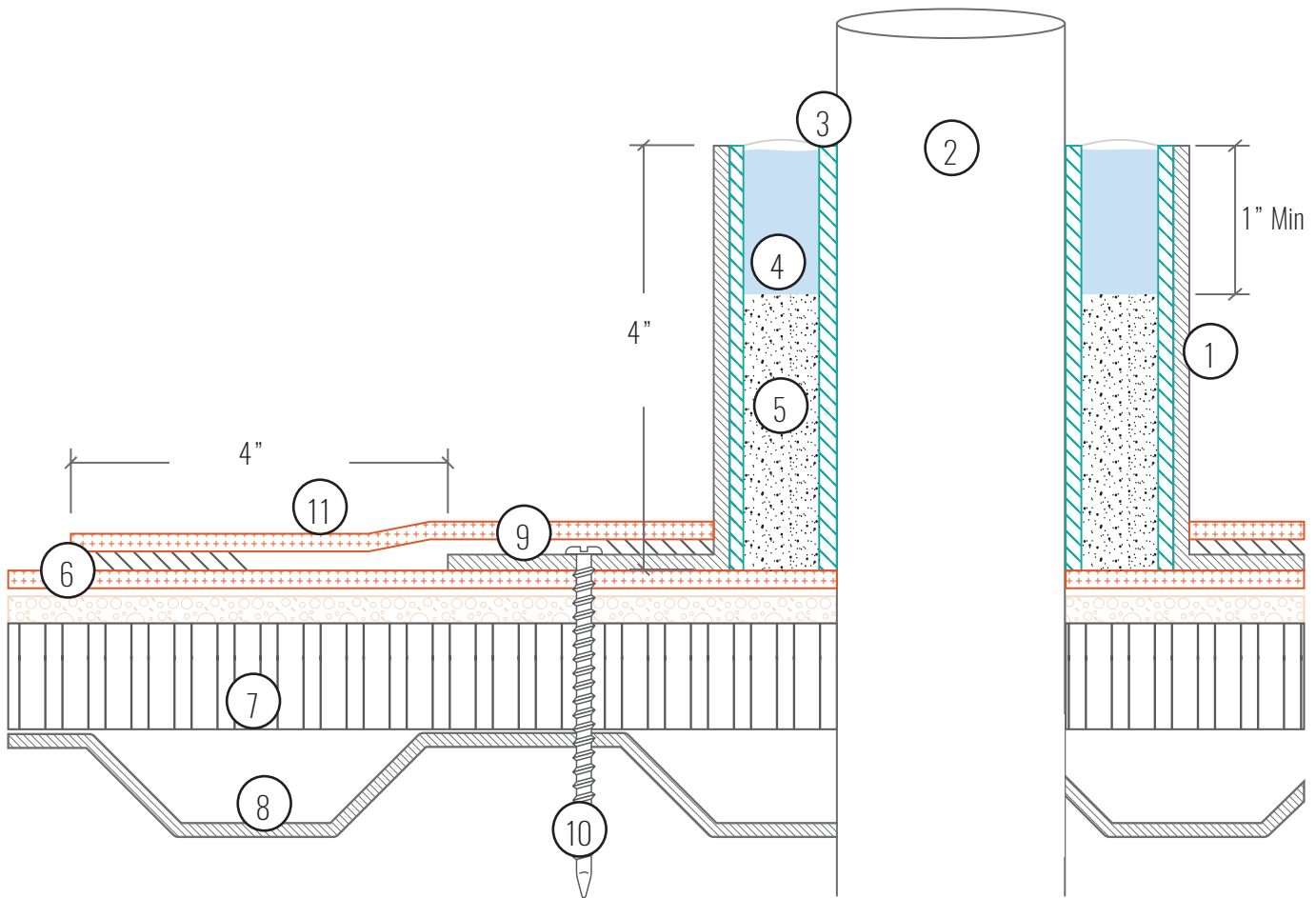

Notes:

- Please refer to the True Seal Specification Manual for approved insulations and cover boards
- Pitch Pan must be securely fastened to the deck with True Seal fasteners at a rate of 8 (minimum) per pitch pocket
- Care must be taken with the application of the sealant and filler/sealer to ensure a closure of the pitch pan to below before the application of the pourable sealer
- Vertical depth of the pourable sealer shall not be less than 1" above the filler/seal and must be concave at the upper surface.
- Field welds of flanges and corners must be a minimum of 1.5" and field weld overlaps from pitch pocket flanges must be a minimum of 4"
- Pitch pockets must be a minimum of 4" high
- Penetration shall not be closer than 1" from the pitch pocket sides.
- Where multiple penetrations are detailed within 1 pitch pocket, there shall be a minimum of 1" separation between penetrations and the edge of the pitch pan.
- Please contact the True Seal Technical Department for clarifications or questions at tech@true-seal.com