

“GRAVEL STOP” PERIMETER EDGE DETAIL MECHANICALLY FASTENED SYSTEM

1. Gravel Stop Metal “Snap Flashing”
2. True Seal™ Flashing Membrane
3. Profile Cleat
4. Approved True Seal™ Fastener
5. Wood Nailer
6. Field Seam (minimum 1.5")
7. True Seal™ Bonding Adhesive

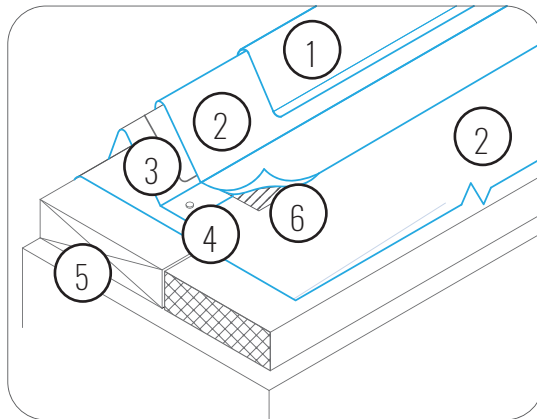
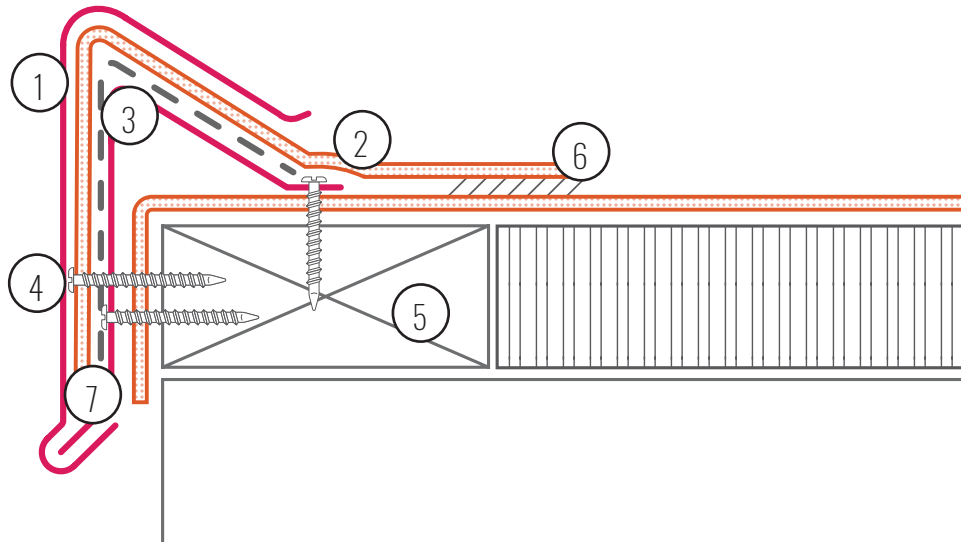

Notes:

- Please refer to the True Seal™ Specification Manual for approved Insulations and Cover Boards
- Wood nailer must be secured as per the requirements contained in the True Seal™ Specifications
- At all times the field seams must be dry before field seam hot air welding
- At all times the field seam must be free of dirt, debris and contaminants before field seam hot air welding.
- True Seal™ Flashing membrane must be fully adhered to profile cleat
- Attachment of the Metal “Snap Flashing” and profile cleat to meet or exceed FM Global guidelines.
- Please contact the True Seal™ Technical Department for clarifications or questions at tech@true-seal.com