

“ZERO EDGE” PERIMETER EDGE DETAIL

1. Approved True Seal™ Insulation and/or Cover Board
2. True Seal™ Membrane
3. Wood Nailer
4. True Seal™ Caulking
5. True Seal™ Termination Bar (Cover Optional)
6. True Seal™ Fastener
7. True Seal™ Term Bar Butyl Tape

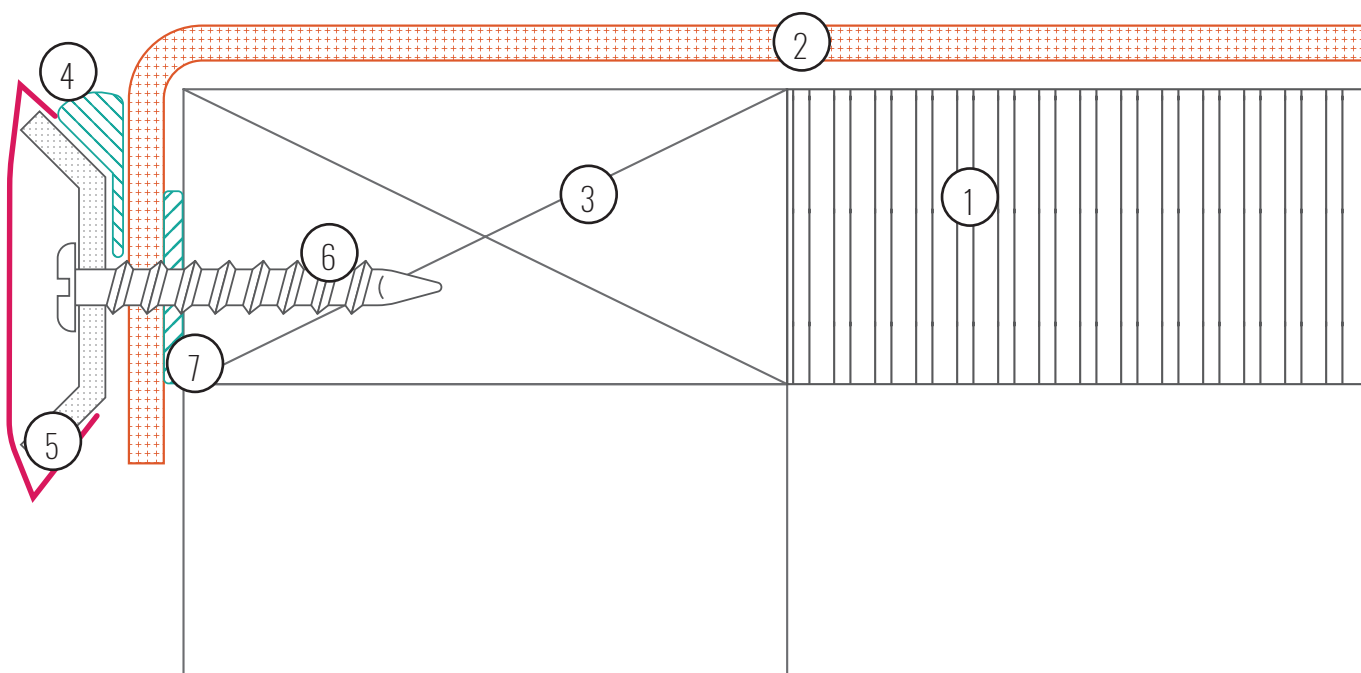

Notes:

- Please refer to the True Seal™ Specification Manual for approved Insulations and Cover Boards
- Wood nailer must be secured (maximum 24" on center) as per the requirements contained in the True Seal™ Specifications or FM global, whichever is greater.
- Wood nailer must be at the same elevation as the insulation or coverboard.
- Outside edge of nailer must be rounded with no sharp edges.
- Termination bar must be secured at 12" on center.
- True Seal™ membrane must end at bottom of termination bar.
- True Seal™ fastener must penetrate term bar butyl tape.
- True Seal™ membrane must be fully adhered with True Seal™ Low VOC bonding adhesive on the horizontal and vertical face of the wood nailer.
- Perimeter securement (mechanical perimeter securement) is required on all True Seal™ Systems.
- Please contact the True Seal™ Technical Department for clarifications or questions at tech@true-seal.com