

FIELD ELEVATION CHANGE TRUE SEAL™ MECHANICALLY FASTENED SYSTEM

1. True Seal™ Membrane
2. True Seal™ Fastener and Metal Membrane Plates
3. Field Seam (minimum 1.5")
4. Approved True Seal™ Insulation and/or Cover Board
5. Roof Deck

6. Approved True Seal™ Bonding Adhesive
7. Approved Metal Snap Fascia Detail
8. True Seal™ Flashing

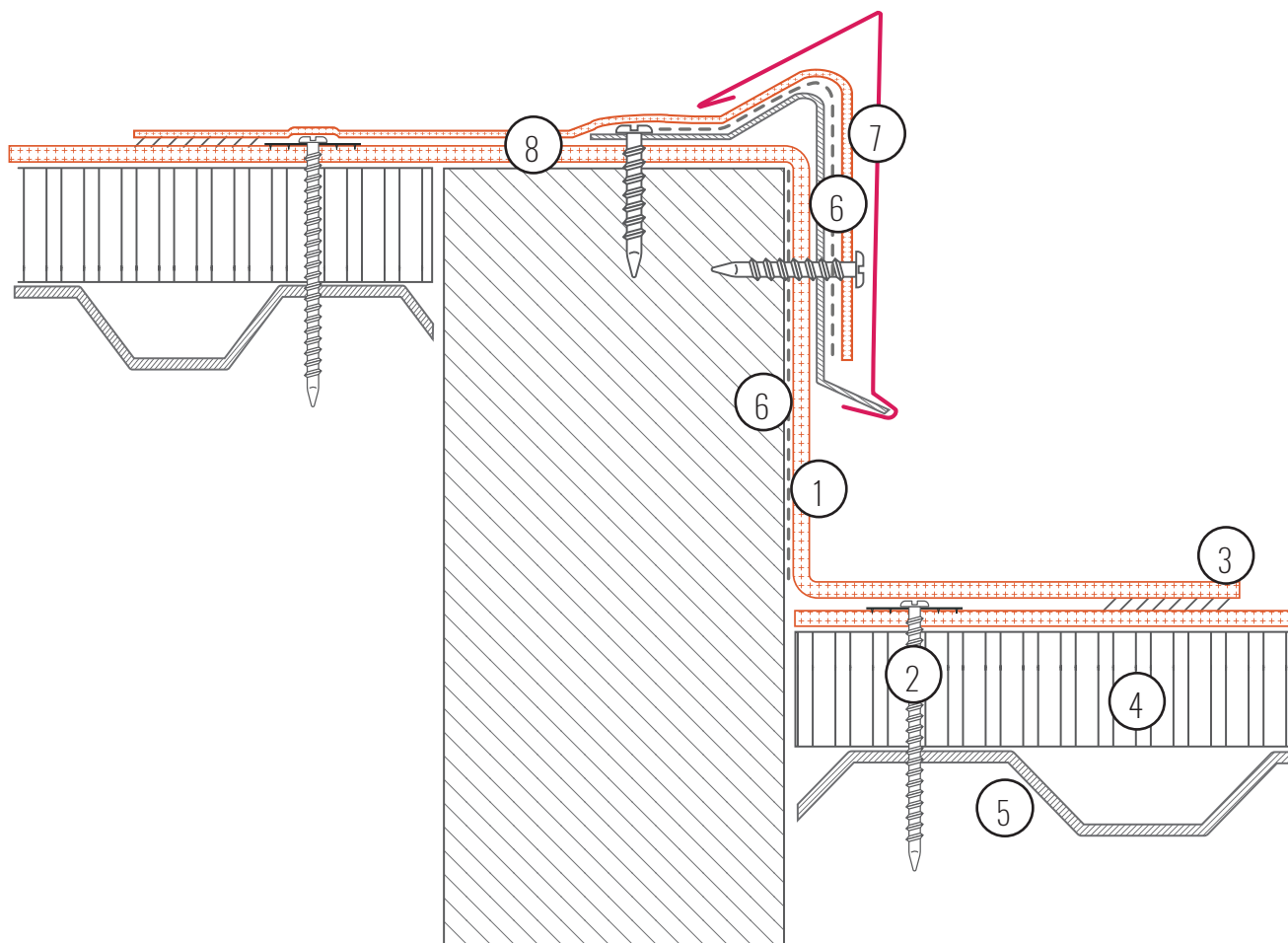

Notes:

- Please refer to the True Seal™ Specification Manual for approved Insulations and coverboards
- At all times, the seam overlap area must be dry before field seam hot air welding
- At all times the seam overlap must be free of dirt, debris and contaminants before field seam hot air welding
- Perimeter securement (mechanical perimeter securement) is required on all True Seal™ Mechanically Fastened Systems. Typical securement is 12" on center.
- True Seal™ flashing is fully bonded with True Seal™ Low VOC adhesive at a typical finished rate of 300 sqft per 5 gal pail.
- Snap fascia profile secured at a minimum of 24" on center in both vertical and horizontal securement
- Please contact the True Seal™ Technical Department for elevation changes greater than 36".
- Please contact the True Seal™ Technical Department for clarifications or questions at tech@true-seal.com