

FULLY ADHERED SYSTEM MEMBRANE SEAM

1. Field Seam (minimum 1.5")
2. Field Seam Overlap (minimum 6")
3. True Seal™ Membrane
4. True Seal™ Bonding Adhesive
5. Approved True Seal™ Insulation and/or Coverboard
6. Roof Deck
7. True Seal™ Fastener and Insulation Plate (Optional)

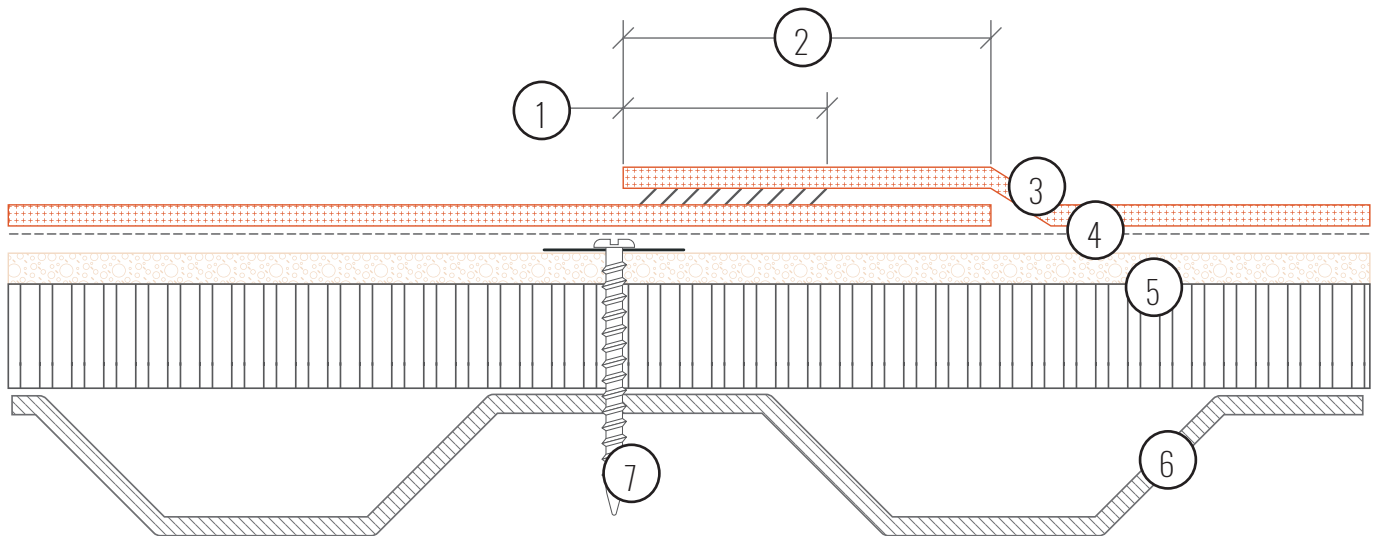

Notes:

- Please refer to the True Seal™ Specification Manual for approved insulations and cover boards
- Typical completed coverage rate for True Seal™ Low VOC @ 60ft²/gallon
- Typical completed coverage rate for True Seal™ Water-Based adhesive is 170ft²/gallon
- Please refer to Detail Series 1400 for Insulation Fastening patterns
- At all times, the seam overlap area must be dry before field seam hot air welding
- At all times, the seam overlap area must be free of dirt, debris and contaminants before field seam hot air welding.
- Please contact the True Seal™ Technical Department for clarifications or questions at tech@true-seal.com