

- 10 threads per inch for ease of installation in concrete roof decks.
- Low profile truss head can be used for clip attachment in applications where head height is important.
- Cathodic Epoxy E-coat

- #3 Phillips recess provides for ultimate bit engagement.
- The reduced drill point provides for ultimate pull-out values by producing a minimum opening.
Thread engagement is superior as compared to standard drill points.

APPLICATION

#14 Fasteners Insulation board to roof deck

Materials:

- Steel thickness from 22 ga (.028 in.) through 18 ga (.045 in.);
Min penetration: 1"
- Plywood: Min thickness: 1/4"
FR treated; min through penetration: 1/4"
- Wood 2x (1-1/2" thick): Min penetration: 1"
- Structural concrete: Min penetration: 1"

Use with:

- 3" round plates
- 2 3/8" round membrane plates
- Other attachment elements approved by the roofing system manufacturer for use with its products

Head: #3 Phillips
Head Height: 0.1165" (2.96)
Head Dia: 0.4364" (11.09)
Thread Major Dia: 0.242" (6.15)
Shank Dia: 0.164" (4.17)

Strength:

Tensile: 3300 lbf (14679 N)
Torsional: 110 lbf·in (12.43 N·m)
Shear: 2100 lbf (9341 N)

Pull-out: (lbs avg.):

22 ga: 540
20 ga: 630
18 ga: 900
4000 psi concrete (1" penetration): 850
3/4" plywood (through penetration): 590
2x dimensional lumber (1" penetration): 605

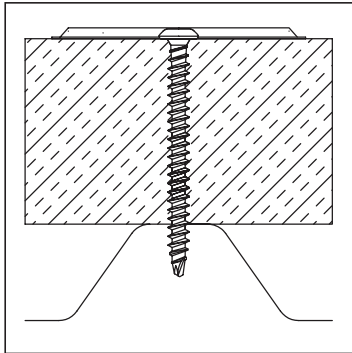

SELECTION

Fastener Length	*Thread Length	Material No. Phillips Head #14-10	Steel	Wood	Carton Wt. (lbs)	Carton Qty.
1-1/4"	Full	1202602	Up to 1/2"	Up to 1/4"	12	1,000
2"	Full	1203249	Up to 1-1/4"	Up to 1-1/4"	19	1,000
3"	Full	1203528	Up to 2-1/4"	Up to 2"	24	1,000
4"	Full	1203578	1-1/4" to 3-1/4"	1-1/4" to 3"	30	1,000
5"	4"	1203605	1-1/4" to 4-1/4"	1-1/4" to 4"	45	1,000
6"	4"	1203632	2-1/4" to 5-1/4"	2-1/4" to 5"	46	1,000
7"	4"	1203659	3-1/4" to 6-1/4"	3-1/4" to 6"	28	500
8"	4"	1203810	4-1/4" to 7-1/4"	4-1/4" to 7"	31	500
9"	4"	1204081	5-1/4" to 8-1/4"	5-1/4" to 8"	34	250
10"	4"	1202260	6-1/4" to 9-1/4"	6-1/4" to 9"	38	250
11"	4"	1202597	7-1/4" to 10-1/4"	7-1/4" to 10"	41	500
12"	4"	1202600	8-1/4" to 11-1/4"	8-1/4" to 11"	45	500

* Note - Thread length measured from tip of the drill point to end of threads.

APPROVALS



State of Florida - FL#: 4500
CE European Technical Approval ETA 09/0375

OPTIONS

Insulation Plates
Membrane Plates
Assemblies