

### INSULATION PLATE

- Flat bottom provides for use on rigid board surfaces.
- Metal plates are stacked for ease of use.

#### APPLICATION

##### Galvalume Steel Insulation Plate

Use with:  
Coverboards and insulation over any deck

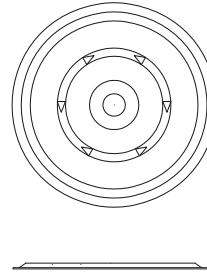
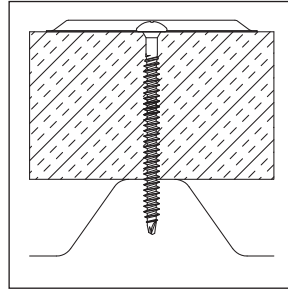

OD: 3"  
ID: .260"  
Thickness: .019"  
Finish: AZ50 Galvalume

#### SELECTION

Item	Carton Wt. (lbs)	Carton Qty.
Galvalume Steel 3" Round Insulation Plate	37	1,000/pail

- Engineered barb design creates maximum wind uplift rating.

##### Galvalume Steel Round 2.4" Barbed MPlate

Use with:  
Steel, Concrete, and Wood Fiber

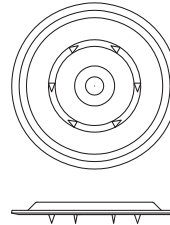
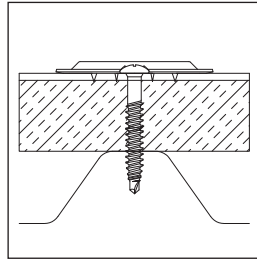

OD: 2.4"  
ID: .265"  
Thickness: .040"  
Finish: AZ-55 Galvalume

#### SELECTION

Item	Carton Wt. (lbs)	Carton Qty.
Barbed Galvalume 2.4" Round Membrane Plate	34	1,000/pail

#### APPROVALS



#### INSTALLATION

Use in applications approved by the roofing system manufacturer.

#### NOTES:

Dimensions are nominal inches unless noted. The specific job conditions should be considered and appropriate safety factors applied when specifying the proper fasteners.