

- Extra stable #3 Phillips drive
- Drill Point design prevents fastener walking
- 13 threads per inch provides higher pull-out values

- Drill point cuts through gravel and BUR
- Cathodic epoxy e-coat

APPLICATION

#15 Phillips Head Insulation board to roof deck

Materials:

- Steel thickness from 26 ga (.019 in.) through 18 ga (.045 in.): Min penetration: 1"
- Plywood: Min thickness 1" FR treated; min through penetration: 1/4"
- Wood 2x (1-1/2" thick): Min penetration: 1"
- Structural concrete: Min penetration: 1"

Use with:

- 3" round plates
- 2 3/8" round membrane plates
- Other attachment elements approved by the roofing system manufacturer for use with its products
- Other attachment elements approved by the roofing system manufacturer for use with its products

Head: #3 Phillips
Head Height: 0.1165" (2.96)
Head Dia: 0.437" (11.09)
Thread Major Dia: 0.26" (6.60)
Shank Dia: 0.204" (5.18)
Threads per Inch: 13

Strength:

Tensile: 4350 lbf (19350 N)
Torsional: 130 lbf-in (14.69 N-m)
Shear: 3700 (16458)

Pull-out: (lbs avg.):

22 ga: 706 20 ga: 898 18 ga: 1140
3/4" plywood (through penetration): 703
2x lumber (1-1/2" penetration): 692
Concrete 4000 psi (1" penetration): 728
Non FM Approved Decks:
26 ga: 301 24 ga: 453

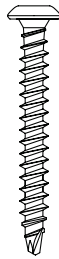
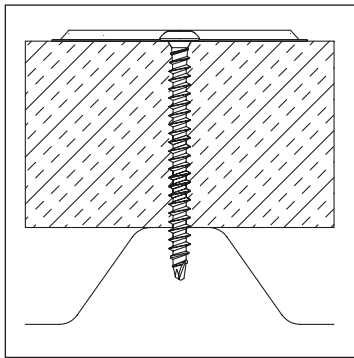

SELECTION

Fastener Length	*Thread Length	Steel	Wood	Carton Wt. (lbs)	Carton Qty.
1-1/4"	Full	Up to 1/4"	Up to 1/4"	13	1,000
2"	1.75"	Up to 1-1/4"	Up to 1"	24	1,000
3"	2.75"	Up to 2-1/4"	Up to 2"	30	1,000
4"	3.75"	1-1/4" to 3-1/4"	1-1/4" to 3"	42	1,000
5"	4"	1-1/4" to 4-1/4"	1-1/4" to 4"	51	1,000
6"	4"	2-1/4" to 5-1/4"	2-1/4" to 5"	30	500
7"	4"	3-1/4" to 6-1/4"	3-1/4" to 6"	35	500
8"	4"	4-1/4" to 7-1/4"	4-1/4" to 7"	40	500
9"	4"	5-1/4" to 8-1/4"	5-1/4" to 8"	45	250
10"	4"	6-1/4" to 9-1/4"	6-1/4" to 9"	49	250
12"	4"	8-1/4" to 11-1/4"	8-1/4" to 11"	29	250
14"	4"	10-1/4" to 13-1/4"	10-1/4" to 13"	34	250
16"	4"	12-1/4" to 15-1/4"	12-1/4" to 15"	38	250

* Note - Thread length measured from tip of the drill point to end of threads.

APPROVALS



State of Florida - FL#: 4500
CE European Technical Approval ETA 09/0375

OPTIONS

Insulation Plates
Membrane Plates
Assemblies

Installation Tools
isoweld®